

Aris Downlight Data Sheet

Driver inside (6W, 2700K, Dimmable)

*Feature:

- HALED optical design, Excellent Light.
- Simple integrated design and easy installation.
- CRI: 95
- Low UGR: ≤ 19
- Dimming Type: dimmable
- Input Voltage: AC200~240V 50/60Hz
- IP Level: IP20.

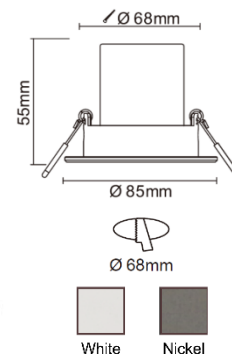

* Photometric Information

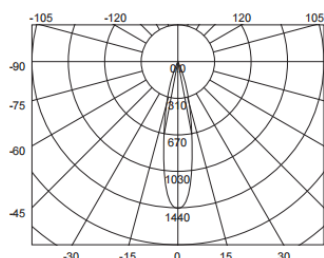

24°/ cd

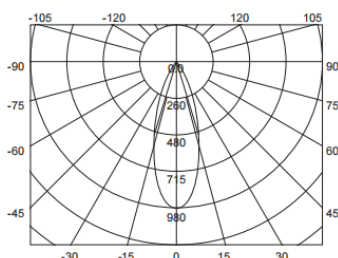

36°/ cd

* Technical data

Electrical specifications

Part No.	CTCA5606DW-41031 CTCA5606DN-41059
Wattage (W)	6W
Frequency (Hz)	50/60
Dimmable	Yes

Photometric specifications

Colour temperature (CCT)	2700K
Luminous efficiency (lm/W)	66
Standard deviation of colour	≤ 3 SDCM
UGR	≤ 19

6Lifespan

Number of switching cycles	100,000-
L80/B10 service life at 25°C	25,000 hrs
Warranty period	3 Years

Mechanical specifications

Housing material	Aluminum
Optical cover/ Lens material	PC
Width/ Diameter	Ø85mm

EAN	4060574410311 4060574410595
AC input voltage (V)	AC200-240V
Power factor	0.9
Flicker-free	Yes

Luminaries Lumen (lm)	400
CRI (Ra)	95
Beam angle (°)	24°/36°
Lux(cd):	1400cd(24°)/ 950cd(36°)

L70/B50 service life at 25°C	30,000 hrs
L90/B10 service life at 25°C	-

Housing Colour	White/ Nickel
Height	55mm
Product weight	200g

Cut hole	Φ68mm
Application parameters	
Working temperature range	-20~+60℃
Package specifications	
Individual package length	105mm
Individual package height	68mm
Driver	-
Shipping box length	550mm
Shipping box height	166mm

Storage temperature range	-20~+70℃
Individual package width	105mm
Gross weight (single item)	220g
Packaging unit	20PCS
Shipping box width	240mm
Gross weight (Shipping box)	-

*Package



85*55mm



105*105*68mm



550*240*166mm(20PCS)

Cautions:

- Power off before replacement
- Do not in violation of any fire regulations when using
- Consult competent electricians for technical support
- If the supply cord is damaged, it shall be exclusively replaced by the manufacture or his service agent o similar qualified person in order to avoid a hazard

* Installation /Mounting:

Please read the entire instruction manual before using the product and save it for future reference. We reserve the right for any errors in text or images and any necessary changes made to technical data. If you have any questions regarding technical problems, please contact our Customer Services.

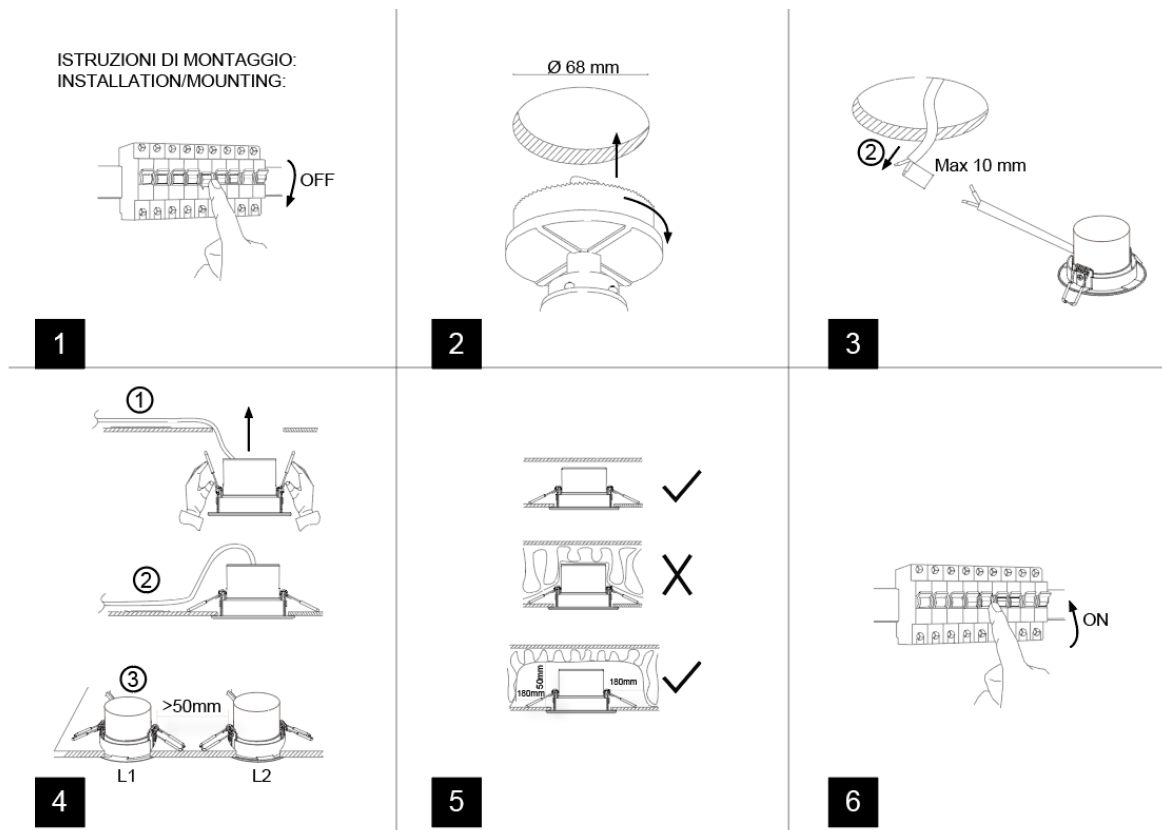

For non replacable lightsources. The light source of this luminaire is not replaceable; when the light source reaches its end of life, the whole luminaire shall be replaced"