

Aris Downlight Data Sheet

Driver outside (12W, 3000K, Dimmable)

*Feature:

- HALED optical design, Excellent Light.
- Simple integrated design and easy installation.
- CRI: 95
- Low UGR: ≤ 19
- Dimming Type: Dimmable
- Input Voltage: AC200~240V 50/60Hz
- IP Level: IP20.



* Photometric Information

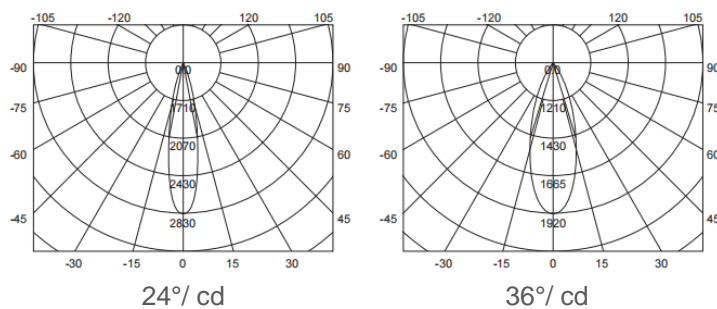

* Technical data

Electrical specifications			
Part No.	CTCA5612PW-41006	EAN	4060574410069
Wattage (W)	12W	AC input voltage (V)	AC200-240V
Frequency (Hz)	50/60	Power factor	0.9
Dimmable	Yes	Flicker-free	Yes
Photometric specifications			
Colour temperature (CCT)	3000K	Luminaries Lumen (lm)	700
Luminous efficiency (lm/W)	58	CRI (Ra)	95
Standard deviation of colour	≤ 3 SDCM	Beam angle (°)	24°/36°
UGR	≤ 19	Lux(cd):	2800cd(24°)/ 1900cd(36°)
6Lifespan			
Number of switching cycles	100,000-	L70/B50 service life at 25°C	30,000 hrs
L80/B10 service life at 25°C	25,000 hrs	L90/B10 service life at 25°C	-
Warranty period	3 Years		
Mechanical specifications			
Housing material	Aluminum	Housing Colour	White
Optical cover/ Lens material	PC	Height	45mm
Width/ Diameter	$\Phi 85$ mm	Product weight	220g
Cut hole	$\Phi 68$ mm		

Application parameters

Working temperature range -20~+60°C

Package specifications

Individual package length 130mm

Individual package height 63mm

Driver -

Shipping box length 580mm

Shipping box height 156mm

Storage parameters

Storage temperature range -20~+70°C

Shipping specifications

Individual package width 110mm

Gross weight (single item) 240g

Packaging unit 20PCS

Shipping box width 290mm

Gross weight (Shipping box) -

***Package**



85*45mm



130*110*63mm



580*290*156mm(20PCS)

Cautions:

- Power off before replacement
- Do not in violation of any fire regulations when using
- Consult competent electricians for technical support
- If the supply cord is damaged, it shall be exclusively replaced by the manufacture or his service agent o similar qualified person in order to avoid a hazard

*** Installation /Mounting:**

Please read the entire instruction manual before using the product and save it for future reference. We reserve the right for any errors in text or images and any necessary changes made to technical data. If you have any questions regarding technical problems, please contact our Customer Services.

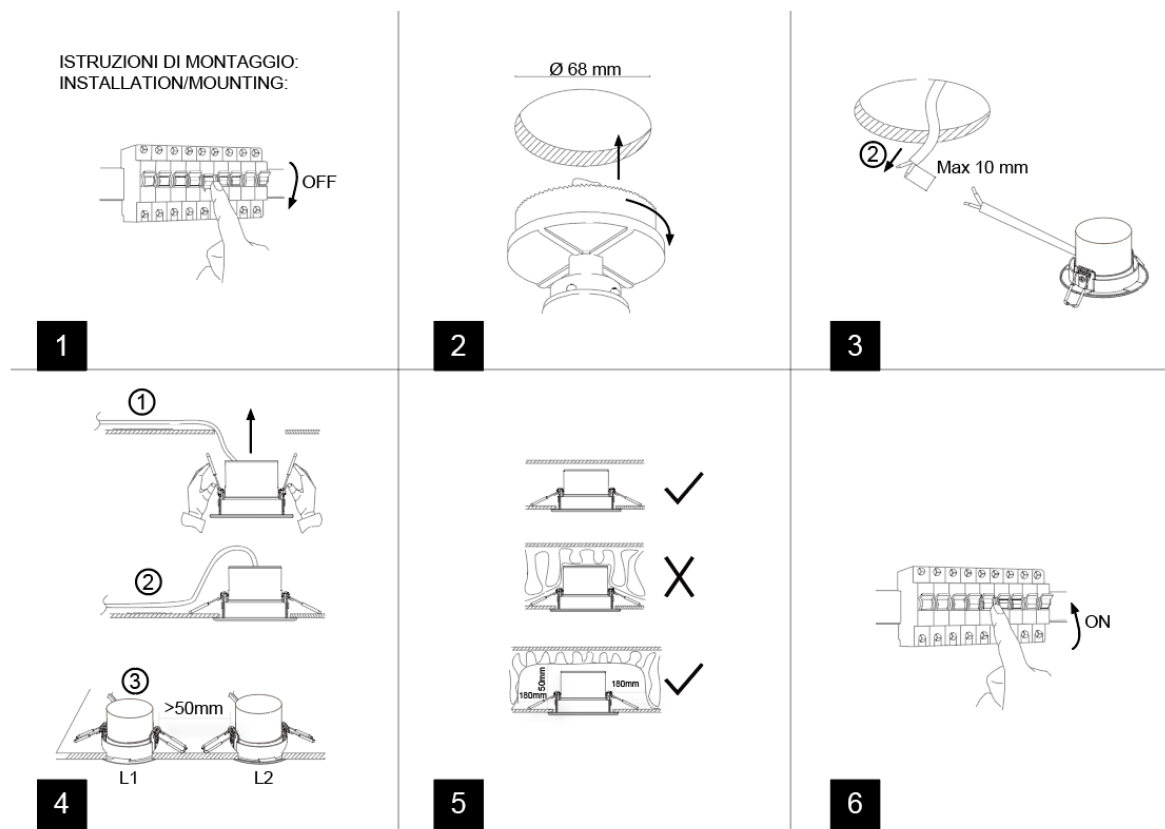

For non-replaceable light sources. The light source of this luminaire is not replaceable; when the light source reaches its end of life, the whole luminaire shall be replaced"